

SPACE CONTAINER

c. goulart / 80

COLLECTION — PICTURES

ACTUAL PAINTINGS AS SHOWN IN A MUSEUM / DOTTED LINES / NAMES / TITLE / ETC THE SIZE / AREA / IS THEIR BASIC RELATION / BESIDES ONE CAN REMEMBER ON THE SPOT OTHER RELATIONS / SO TO SAY THEY WERE THERE OR THEY WILL BE THERE MANGED. / THE RELATION BETWEEN THEIR AREAS IS THE OBVIOUS POINT. BESIDE THE CONCEPT AND THE AESTHETICAL CONOTATIONS THE COLLECTION IS ~~AN~~ A HISTORICAL COMMENT. ON THE HISTORY OF VISUAL ARTS

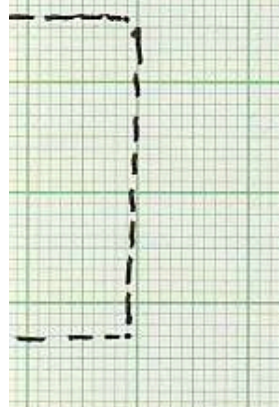

CONTAINER

ACTUAL OUTLINE OF THE ACTUAL SPACE / ARCHITECTURAL SPACE / AS A CUBE / SPACE / FROM TRADITIONAL SCULPTURE / ~~TO~~ TO OBJECTS / ENVIRONMENTS / ~~LIBERATIONS~~ / LIVE SCULPTURE / BEHAVIOR / TO ARCHITECTURE. THE CONTAINER IS ~~THE~~ ~~LEGAL~~ ~~RECIPIENT~~ SPACE DELIMITED BY THE INTERSECTION OF MORE THAN THREE PLANS / IT CONTAINS MATERIALS / OBJECTS ARRANGED IN A CERTAIN WAY OR NOT / DEPENDING OF THE RELATIONS WITH THE CONTAINER OR NOT / PEOPLE DOING ART OR SEEING ART OR JUST LIVING / ARCHITECTURAL SPACE / ~~BECAUSE~~ SCULPTURE HAS BECOME MORE AN ARCHITECTURAL ELEMENT THAN AN ORNAMENT OF ARCHITECTURAL SPACES / WHEN AN INDEPENDENT PIECE (OF THE ARCHITECTONIC SURROUNDINGS) EVEN THEN WITH ~~BECAUSE~~ ARCHITECTONIC CONOTATIONS. THE RESULTS DROWN IN LINE:

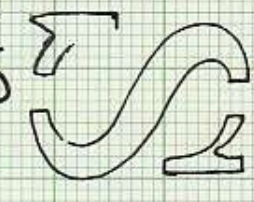
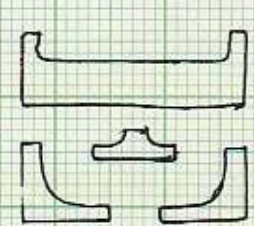
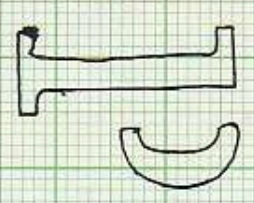
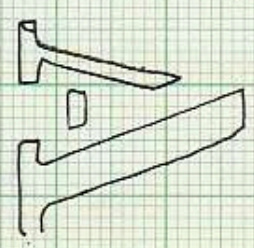
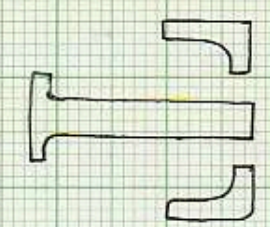

(ADHESIVE)

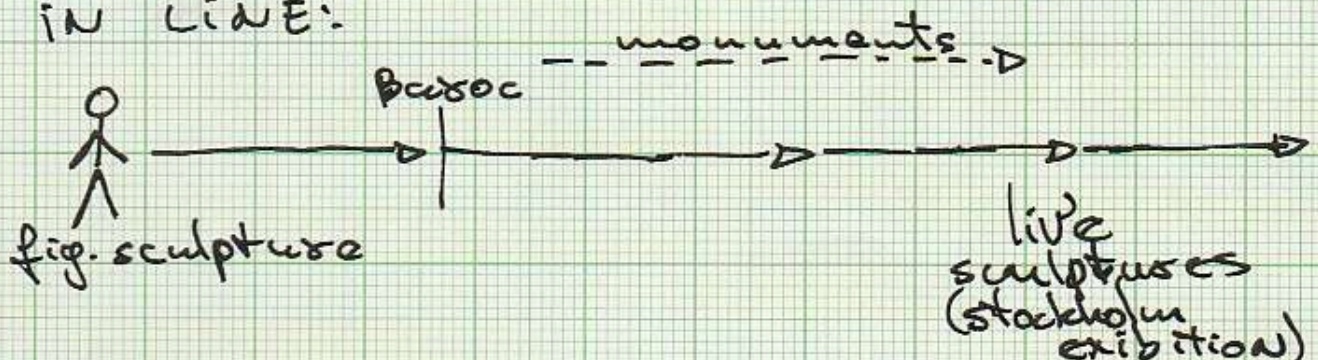

THE CONTAINER CAN BE A EXHIBITION ROOM / AN ATELIER / A HOUSE / A DELIMITED OPEN SPACE ETC / ETC /

EFFECT — ACTUAL ROOM OUTLINED / BLACK OUT / FLOURESCENT PAINTED TAPE / ACTUAL ROOM OUTLINED / CHANGE THE SPACE / GAME.

ACTION — PERFORMANCE (IN LARGE SENCE) from close pieces / to political action / or daily life.

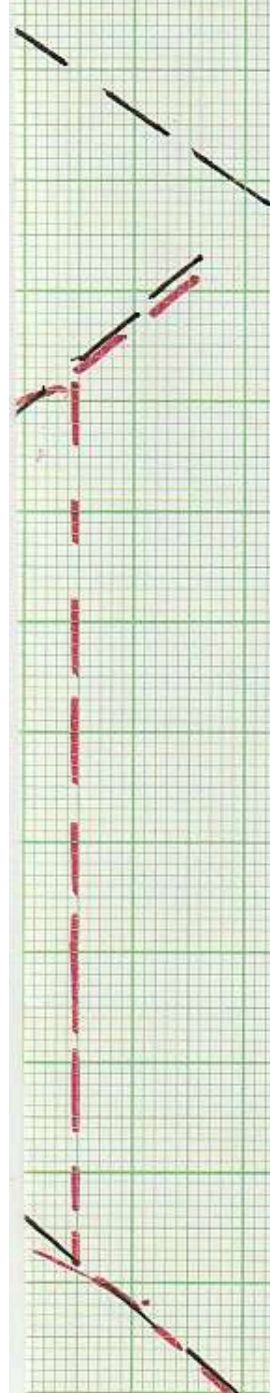
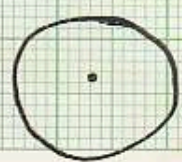

AREA — plano

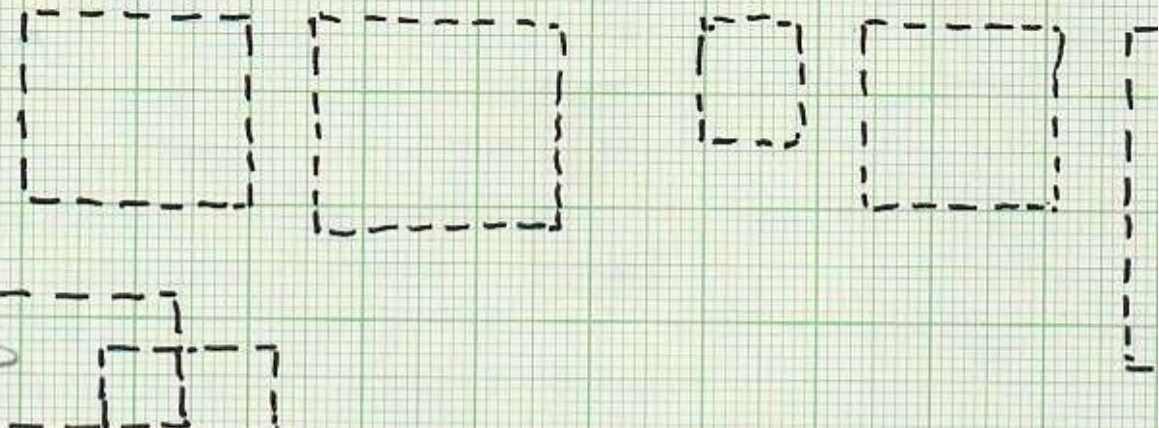

pictures to be
hung
(forgot them)

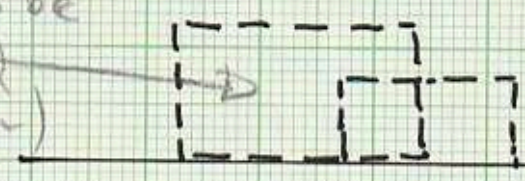

escultura

SPACE — contains

- ~~objeto~~ volume
- massa material
- objeto(s)
- ambiente/atmosfera
- behavior/architecture

environment

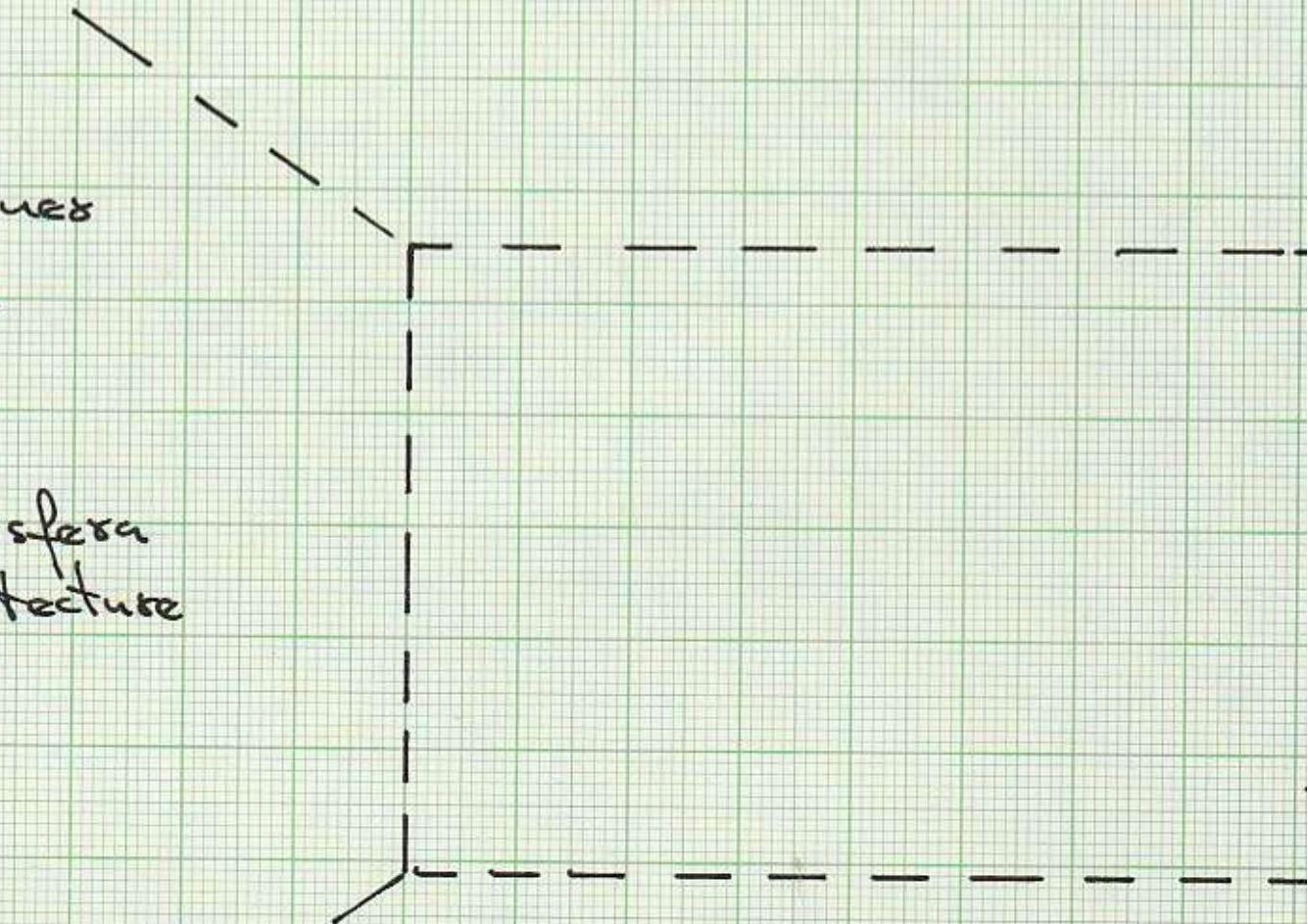

EFFECT

lines with lights

lines when room
in black out

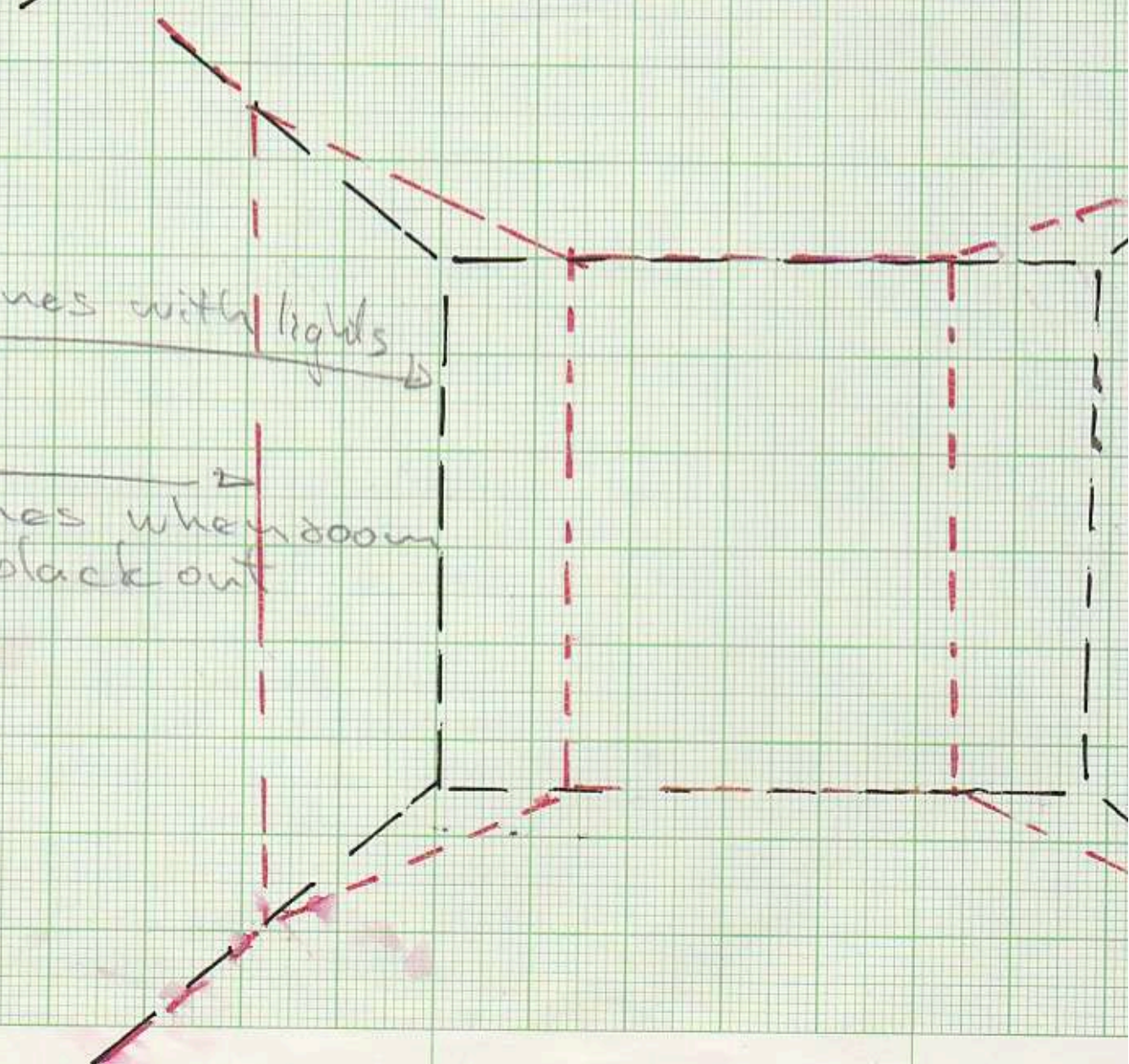

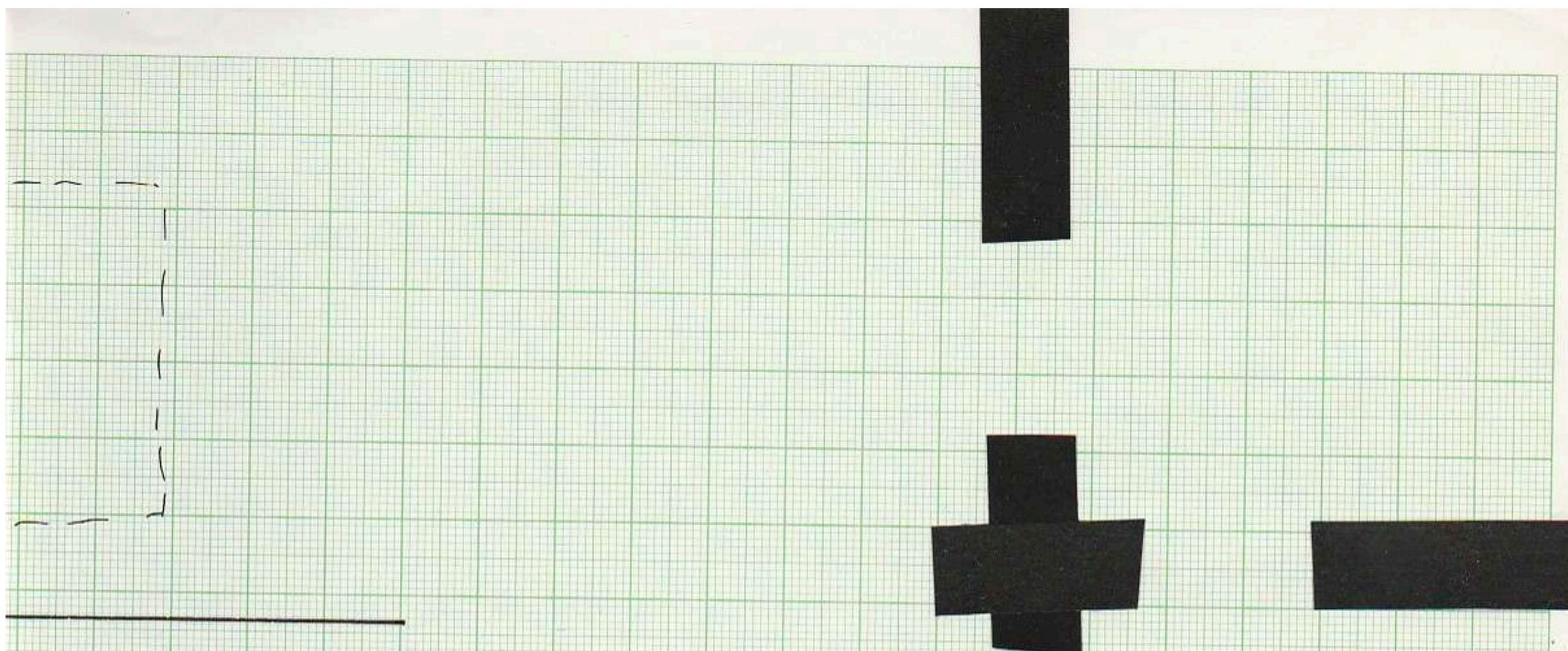

CATALOGUE'S PAGE /
SIZES IN THE PAGE) } outlined
size

ALL
REAL SIZE



SIDE PLACE'S
SIDE / STREETS

ENTS
DIN A STAIRCASE M. DUCHAMP.

at the sleeping room

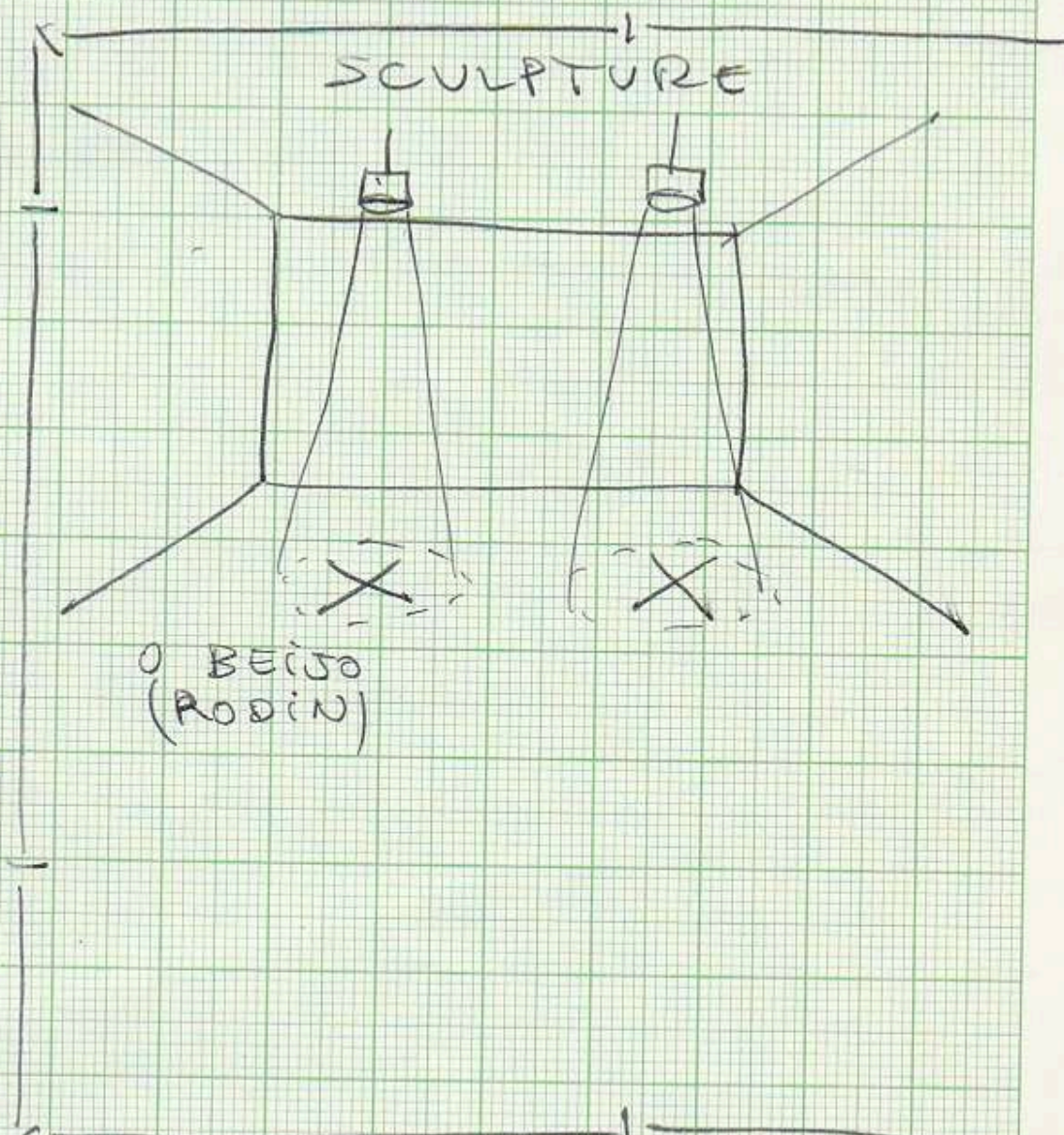

ical development
sizes of pictures in every page

folded
unfolded



pictures forming actual space
where the rate

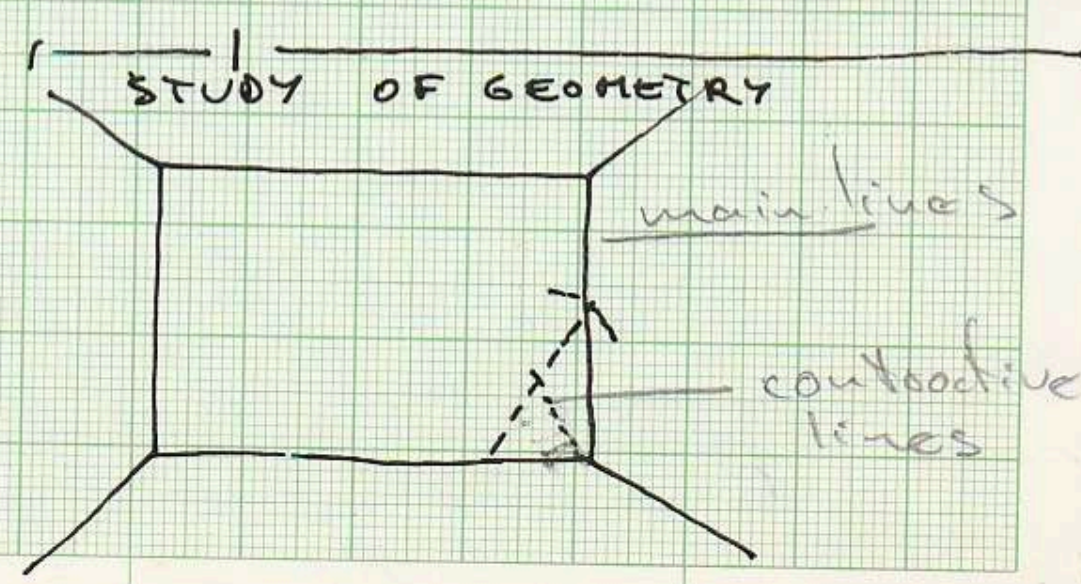
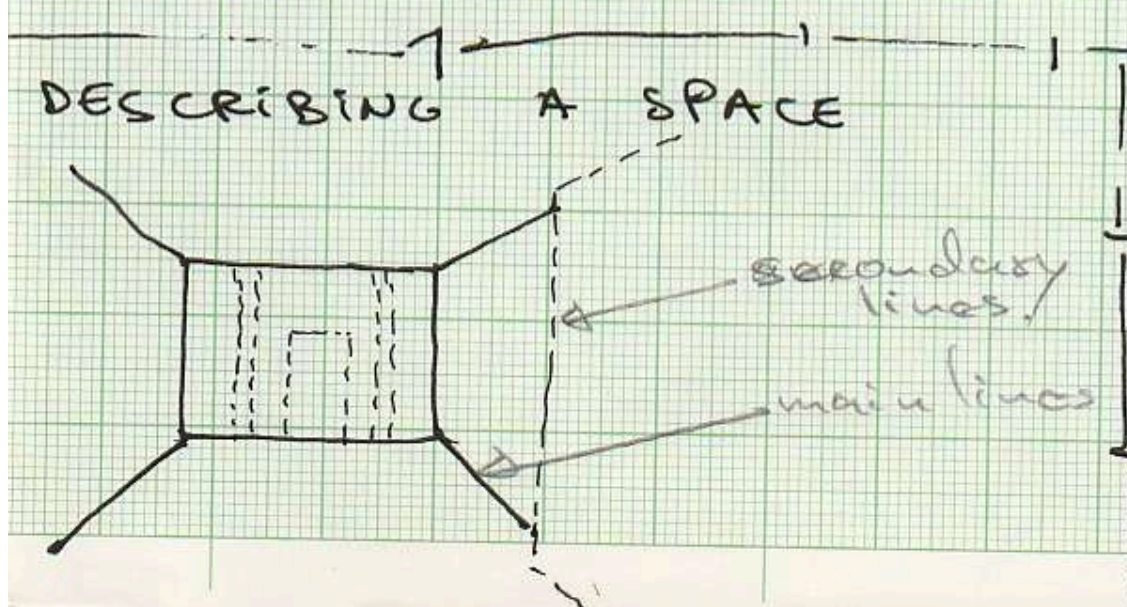

IMAGES IN THE SPACE / REAL SIZE

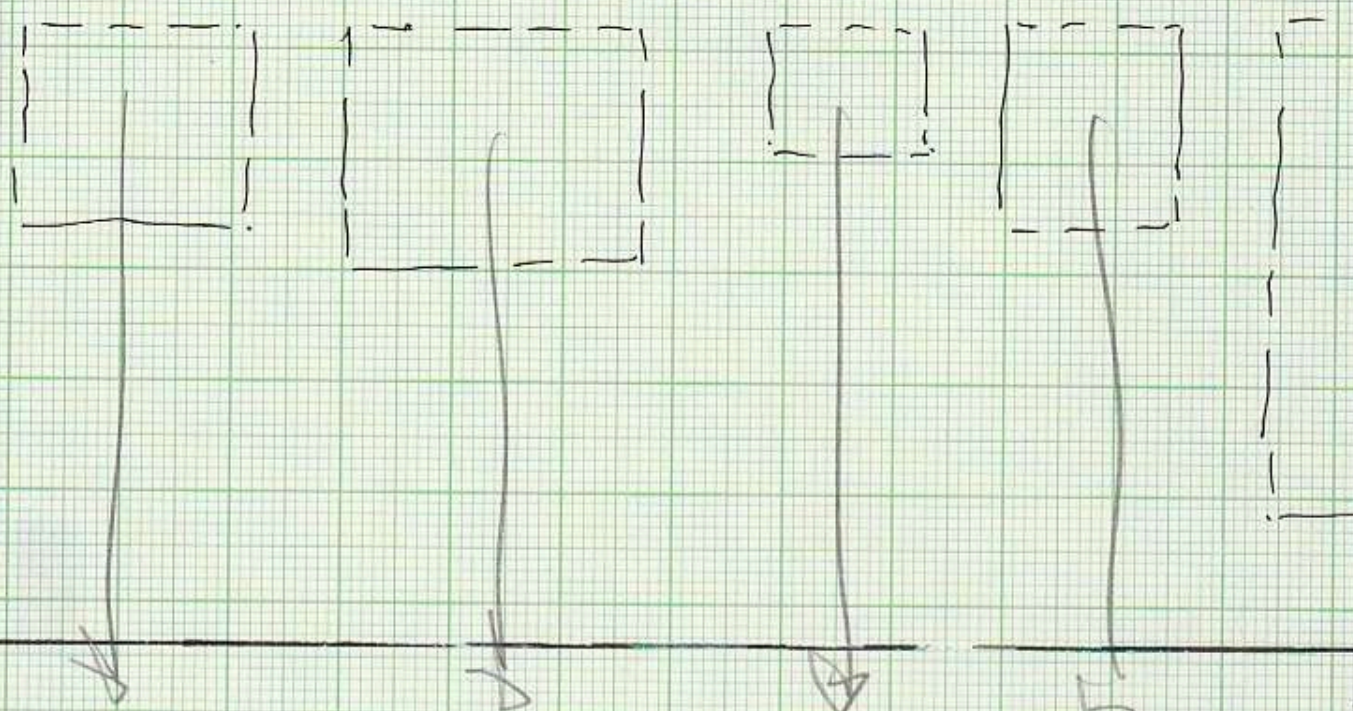

- IMAGES AS SEEN IN THE CATALOGUE / SIZE OF PICTURE OR (AT THE WALLS BUT SIZE RELATED TO THE PICTURE)
- IMAGES ~~NOT~~ SEEN ~~FOR THEM~~ WITH THE SAME
- ACTUAL IMAGES {
 - WITH THE SAME SIZE
 - KEEP IN RELATION WITH REALITY

- SERIE OF FOTOS {
 - OUTLINED SPACES IN
 - FOTOS WITH COLOURS
EX: NUDE DESSEIN
 - FOTOS OF DETAILS
EX: X X
X X

- BOOK {
 - project / showing crowd
 - serie of pages with the
 - catalogue of paintings

CHANGING SPACES / ILUSIONARY GAMES

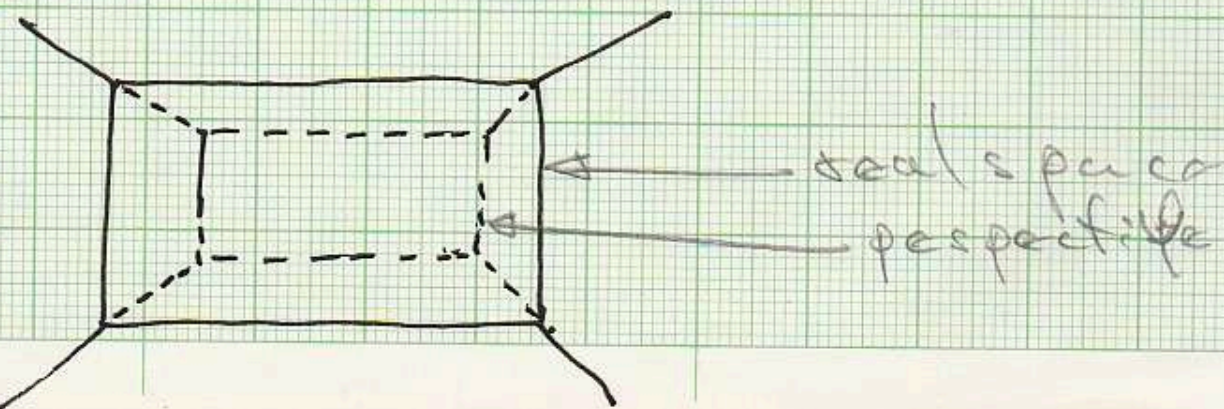

IMAGES IN THE SPACE / REAL SIZE

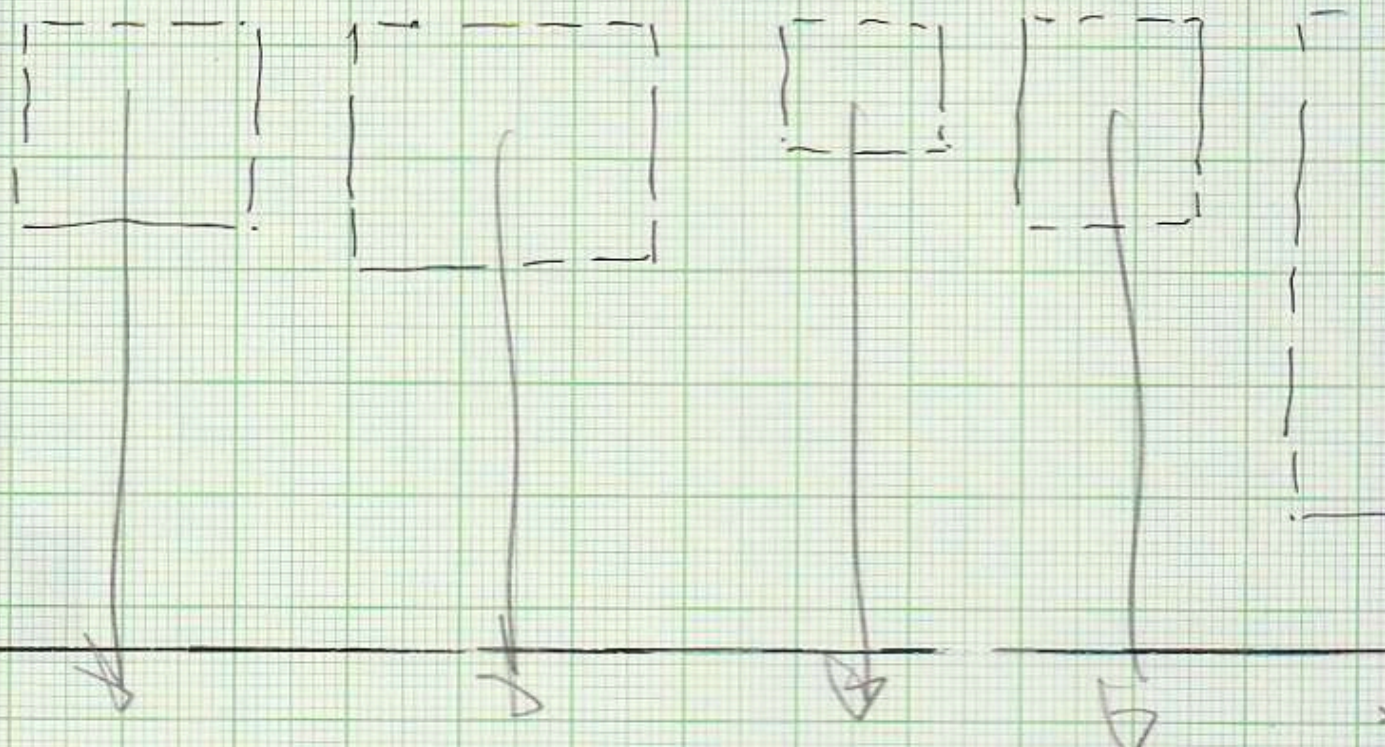

- IMAGES AS SEEN IN THE CATALOGUE / SIZE OF P OR (AT THE WALLS BUT SIZE RELATED TO THE PA
- IMAGES ~~NOT~~ SEEN ~~NOT~~ WITH THE SAME
- ACTUAL IMAGES {
 - WITH THE SAME SIZE
 - KEEP IN RELATION WITH

- SERIE OF FOTOS {
 - OUTLINED SPACES i
 - FOTOS WITH CO
EX: NUDE DESSE
 - FOTOS OF DETAILS
EX: X X
X X

- BOOK {
 - project / showing crowd
 - serie of pages with the
 - catalogue of paintings

CHANGING SPACES / ILUSIONARY GAMES

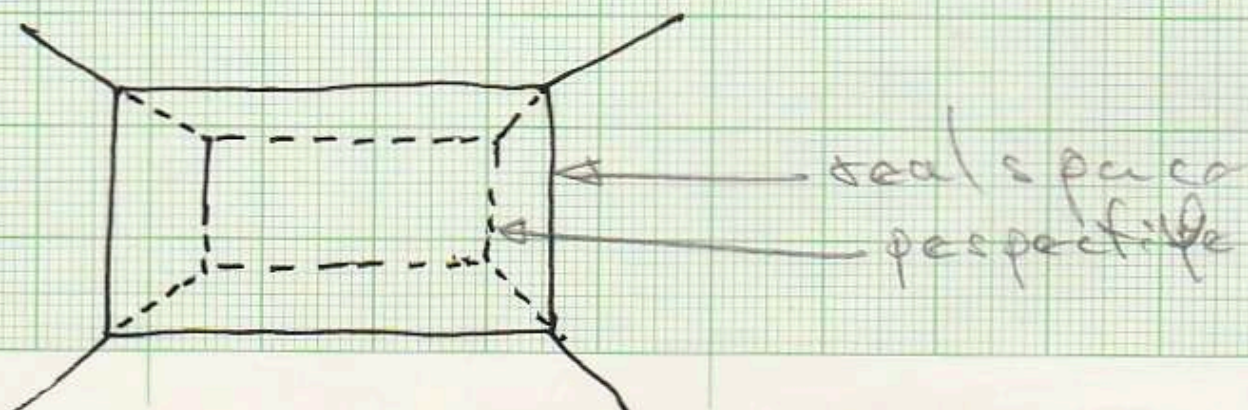



CATALOGUE'S PAGE /
SIZES IN THE PAGE) } outlined

ALL
REAL SIZE



SIDE PLACES
SIDE / STREETS

ENTS
DIN A STAIRCASE M. DUCHAMP.

at the sleeping room

ical development

sizes of pictures in every page

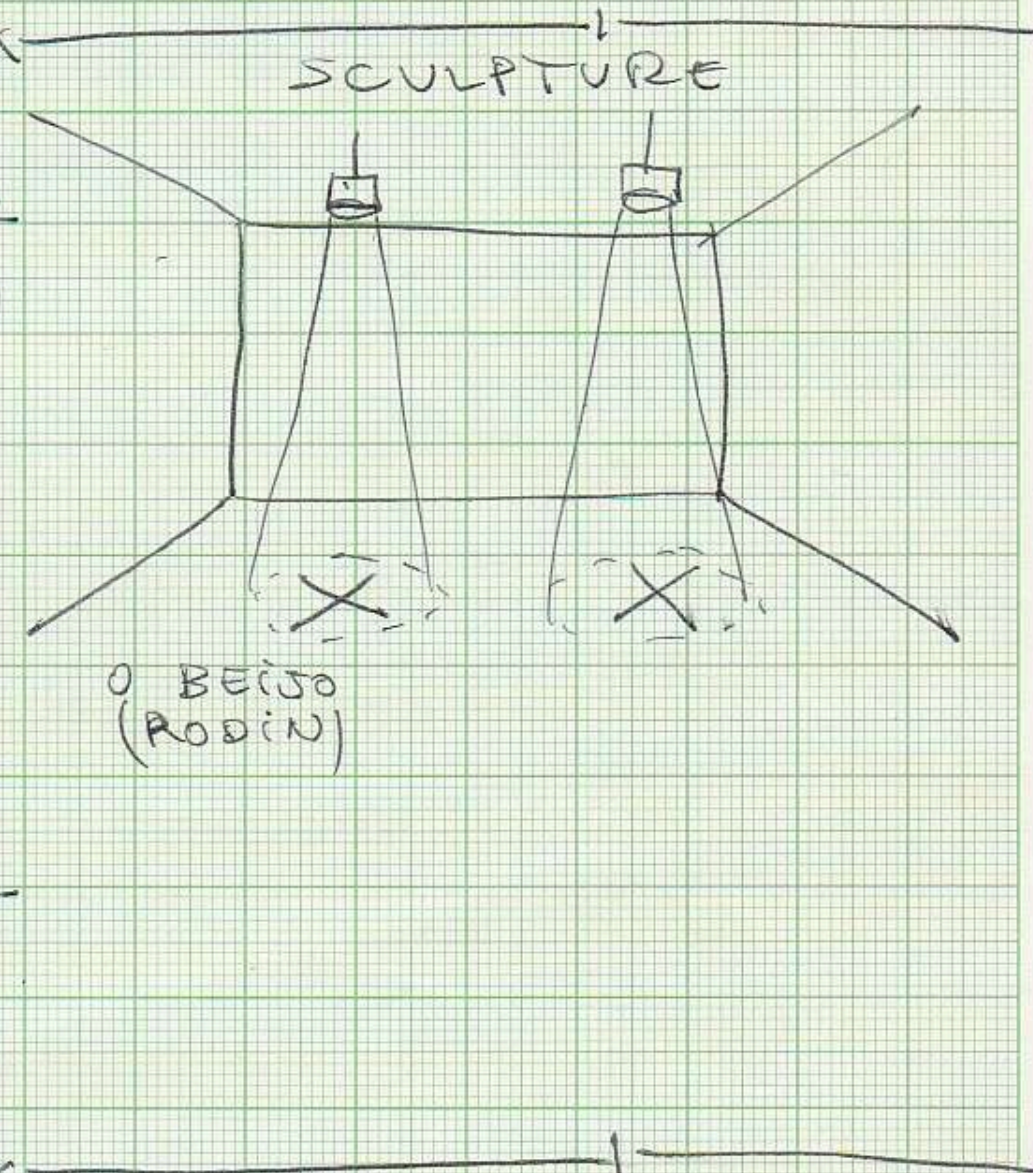

folded



unfolded

pictures forming actual space
whose thickness

DESCRIBING A SPACE

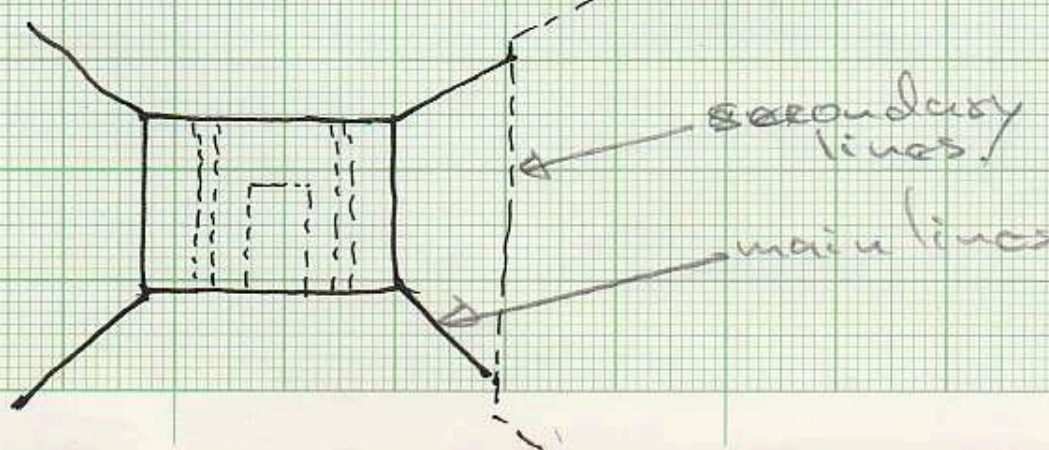

STUDY OF GEOMETRY

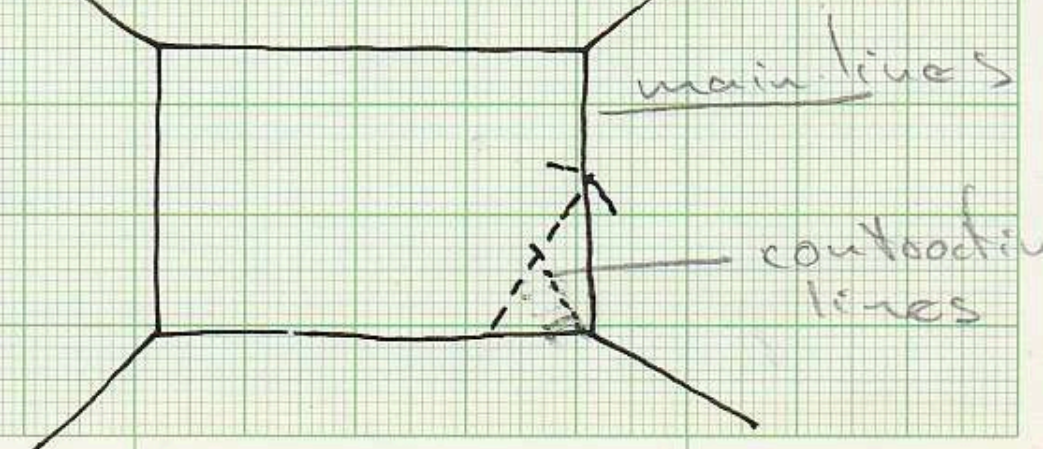

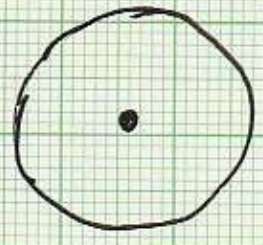

ACTION / EVENT / HAPPENING / PERFORMANCE

— a person brushing the floor of

— projection of a slide of stu
my body / coinciding. (RELATION
white plan clothes / so tha

the collection's space

, for human proportions / ~~DAVID~~ DURER / life size / over
IMAGE / PLAN - SCULPTURE / VOLUME)
the projection is clear over the body.

